

## TS 2000 TUBE TO TUBESHEET WELDING HEAD

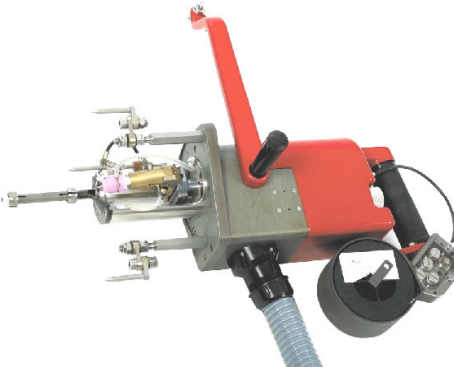

*TS 2000 with integrated wire feeder*

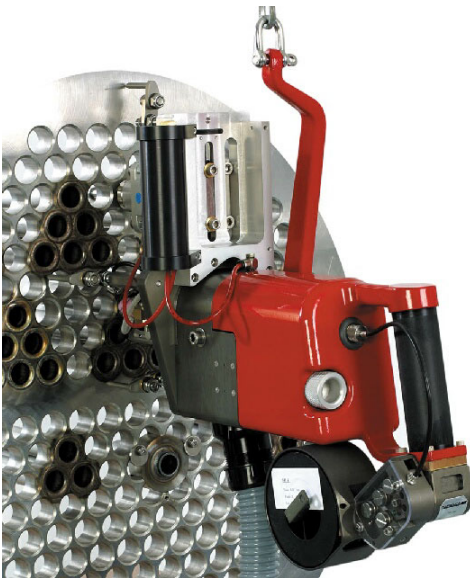

*TS 2000 with pneumatic holding device*

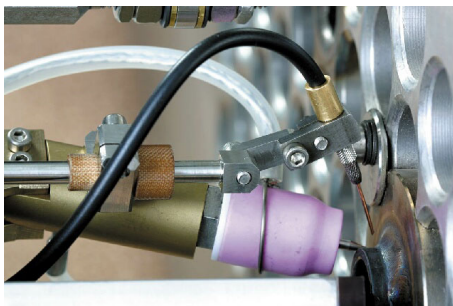

*Torch TS 2000 with wire guide*

### **TECHNICAL SPECIFICATION**

- Constant welding speed and torch prepositioning mechanism in relation to the weld cycle
- Robust welding head avoiding vibrations during operation under critical applications
- Welding head is centered to the tube via a centering mandrel
- Water cooled torch
- Possibility to use pulsed current with synchronised pulsed rotation
- AVC height sensing or programmed electrode / workpiece fixed height in option

### **PROCESS**

Designed for the automatic TIG orbital welding of tubes to tubesheets in high duty cycle, with or without filler wire

### **POSSIBLE APPLICATIONS**

- Tubes recessed in the plate (max. 2 mm)
- Tubes flushed to plate surface
- Tubes protruding (max. 13 mm)

### **FIELDS OF INDUSTRY**

- Heating and ventilation : production of heat exchangers
- Aerospace / aeronautics
- Microelectronics
- Measurement sensors

### **OPTIONS**

- Pneumatic positioning system

### **ACCESSORIES**

- Protection case with foam interior
- Cables and hoses (length 9 m)
- Balancer
- Electrodes ground to suitable length

**TECHNICAL DATA TS 2000**

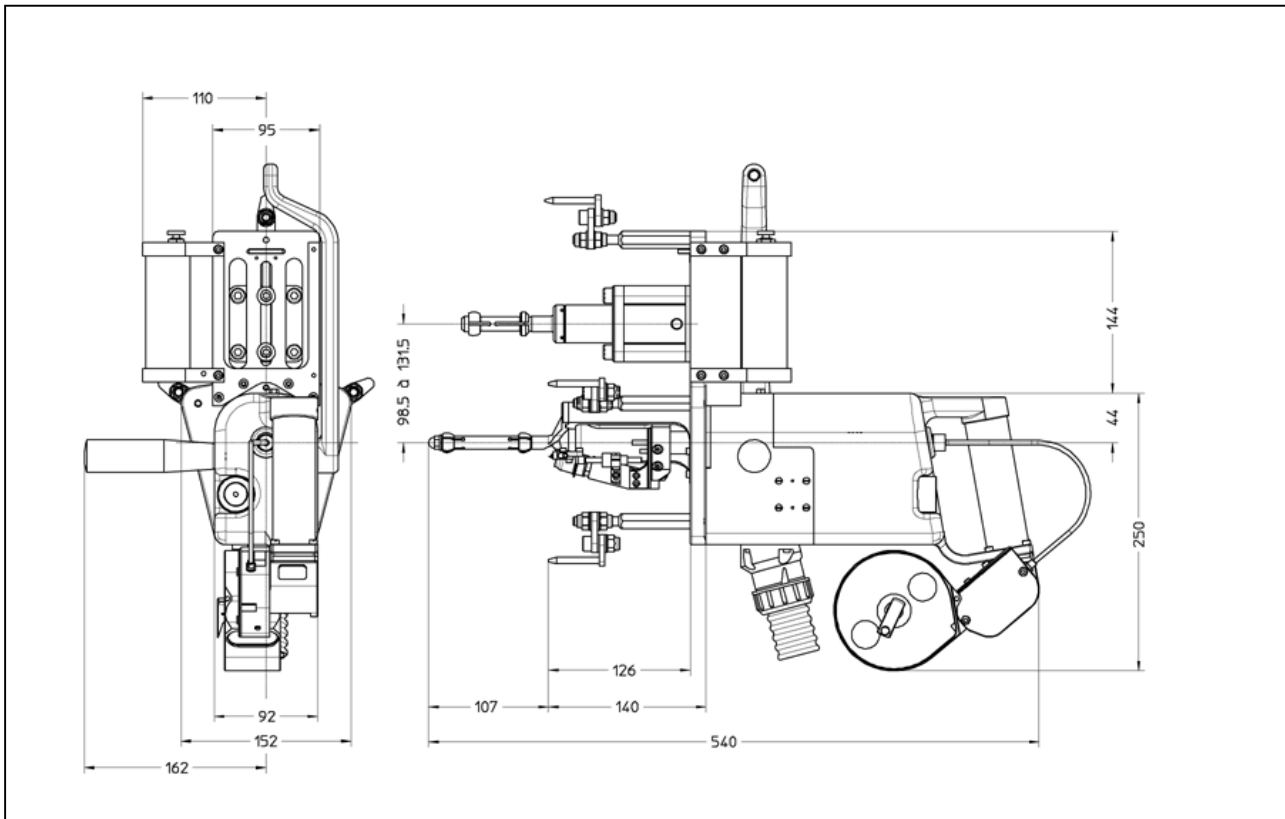

<b>TS 2000</b>	
<b>Min. tube I.D.</b>	10
<b>Max. tube O.D. (in mm)</b>	60
<b>Capacity</b>	200 A
<b>Torch cooling</b>	Water
<b>AVC</b>	○
<b>Wire feeder</b>	○
<b>Wire spool size</b>	∅100 mm 1,5 kg
<b>Welding of tubes :</b>	
- flush	●
- recessed	max 2 mm
- protruding	max 13 mm
- behind tubesheet	○
<b>Positioning on the tube sheet</b>	Centering mandrel
<b>Internal welding</b>	○
<b>Weight</b>	11 kg (with positioning system and integrated wire feeder)
<b>Pneumatic positioning system</b>	○
● Standard	
○ Option	
Non available	

